

Spectrum F202-BBBBBB-CC-DD-EE-FF

Explosion-Proof 2MP, 4MP, 6MP & 8MP (4K) Fixed Cameras

EXPLOSION
PROOF CAMERA

Key Features

- Excellent Image Quality 2MP, 4MP, 6MP & 8MP (4K)
- Pelco Smart Analytics inside
- Cloud-based AI Intelligence
- POE and Redundant DC Power
- 4G and 5G Wireless options available
- SFP Media Converter option available
- Rapid Installation Time with reduced costs
- Operating Temperature
 - See table on Page 2
- Front Glass Protective Film (F2XX-TO) included
- Reliable Securing Kit (SF-RSK) included
- Made in USA
- NDAA and TAA-Compliant
- cFMus, Class I/II/III, Division 1, Groups BCDEFG
II 2 G Ex db IIB+H2 Gb
II 2 D Ex tb IIIC Db,
- IECEx & ATEX approved
- 5 Year Warranty with Registration



All cameras are supplied with the F2XX-GM mount, as shown.



Pelco Camera Inside



Part No.	Description	MP	F Number	i-CS Lens	Image Sensor
F202-SRXE4P-2-IBX-1-01-01	POE - IEEE 802.3bt - 90W	2.0	1.4	3.9 - 10mm	1 / 2.8
F202-SRXE4P-2-IBX-1-02-02	Media Converter (SFP) - 120 / 240 VAC - 50 / 60 Hz	2.0	1.4	3.9 - 10mm	1 / 2.8
F202-SRXE4P-2-IBX-1-02-03-02-RUT241	Wireless - Teltonika 4G - 120 / 240 VAC - 50 / 60 Hz	2.0	1.4	3.9 - 10mm	1 / 2.8
F202-SRXE4P-2-IBX-1-02-03-03-XR60	Wireless - Sierra 5G - 120 / 240 VAC - 50 / 60 Hz	2.0	1.4	3.9 - 10mm	1 / 2.8
F202-SRXE4P-4-IBX-1-01-01	POE - IEEE 802.3bt - 90W	4.0	1.3	3.9 - 10mm	1 / 1.8
F202-SRXE4P-4-IBX-1-02-02	Media Converter (SFP) - 120 / 240 VAC - 50 / 60 Hz	4.0	1.3	3.9 - 10mm	1 / 1.8
F202-SRXE4P-4-IBX-1-02-03-02-RUT241	Wireless - Teltonika 4G - 120 / 240 VAC - 50 / 60 Hz	4.0	1.3	3.9 - 10mm	1 / 1.8
F202-SRXE4P-4-IBX-1-02-03-03-XR60	Wireless - Sierra 5G - 120 / 240 VAC - 50 / 60 Hz	4.0	1.3	3.9 - 10mm	1 / 1.8
F202-SRXE4P-6-IBX-1-01-01	POE - IEEE 802.3bt - 90W	6.0	1.3	3.9 - 10mm	1 / 1.8
F202-SRXE4P-6-IBX-1-02-02	Media Converter (SFP) - 120 / 240 VAC - 50 / 60 Hz	6.0	1.3	3.9 - 10mm	1 / 1.8
F202-SRXE4P-6-IBX-1-02-03-02-RUT241	Wireless - Teltonika 4G - 120 / 240 VAC - 50 / 60 Hz	6.0	1.3	3.9 - 10mm	1 / 1.8
F202-SRXE4P-6-IBX-1-02-03-03-XR60	Wireless - Sierra 5G - 120 / 240 VAC - 50 / 60 Hz	6.0	1.3	3.9 - 10mm	1 / 1.8
F202-SRXE4P-8-IBX-1-01-01	POE - IEEE 802.3bt - 90W	8.0	1.3	3.9 - 10mm	1 / 1.8
F202-SRXE4P-8-IBX-1-02-02	Media Converter (SFP) - 120 / 240 VAC - 50 / 60 Hz	8.0	1.3	3.9 - 10mm	1 / 1.8
F202-SRXE4P-8-IBX-1-02-03-02-RUT241	Wireless - Teltonika 4G - 120 / 240 VAC - 50 / 60 Hz	8.0	1.3	3.9 - 10mm	1 / 1.8
F202-SRXE4P-8-IBX-1-02-03-03-XR60	Wireless - Sierra 5G - 120 / 240 VAC - 50 / 60 Hz	8.0	1.3	3.9 - 10mm	1 / 1.8

For other combinations and selection matrix data sheet please visit <https://spectrumcamera.com>

Specifications

General	
Casing	Aluminum
Weight	27 - 29 lbs (12.2 - 13.2 kgs)
Dimensions	19.25(L) x 7.41(H) x 6.64(W) in (498 x 188 x 163 mm)
Power	See models shown on previous page, or on Selection Matrix Data Sheet
Storage Conditions	-40°C to +60°C (-40°F to +140°F) Humidity 5-95% RH (non-condensing)
Operating Conditions	

Part No.	Certified Temperature °C (°F)	Part No.	Certified Temperature °C (°F)
F202-SRXE4P-2-IBX-1-01-01	-50 to +65°C (-58 to +149°F)	F202-SRXE4P-6-IBX-1-01-01	-50 to +65°C (-58 to +149°F)
F202-SRXE4P-2-IBX-1-02-02	-50 to +65°C (-58 to +149°F)	F202-SRXE4P-6-IBX-1-02-02	-50 to +65°C (-58 to +149°F)
F202-SRXE4P-2-IBX-1-02-03-02-RUT241	-40 to +65°C (-40 to +149°F)	F202-SRXE4P-6-IBX-1-02-03-02-RUT241	-40 to +65°C (-40 to +149°F)
F202-SRXE4P-2-IBX-1-02-03-03-XR60	-40 to +65°C (-40 to +149°F)	F202-SRXE4P-6-IBX-1-02-03-03-XR60	-40 to +65°C (-40 to +149°F)
F202-SRXE4P-4-IBX-1-01-01	-50 to +65°C (-58 to +149°F)	F202-SRXE4P-8-IBX-1-01-01	-50 to +65°C (-58 to +149°F)
F202-SRXE4P-4-IBX-1-02-02	-50 to +65°C (-58 to +149°F)	F202-SRXE4P-8-IBX-1-02-02	-50 to +65°C (-58 to +149°F)
F202-SRXE4P-4-IBX-1-02-03-02-RUT241	-40 to +65°C (-40 to +149°F)	F202-SRXE4P-8-IBX-1-02-03-02-RUT241	-40 to +65°C (-40 to +149°F)
F202-SRXE4P-4-IBX-1-02-03-03-XR60	-40 to +65°C (-40 to +149°F)	F202-SRXE4P-8-IBX-1-02-03-03-XR60	-40 to +65°C (-40 to +149°F)

Approvals	Hazardous Area FM3600, FM3615, ANSI/ISA/EN/IEC/CAN/ CSA-C22.2 60079-0, ANSI/UL/EN/IEC/CAN/ CSA-C22.2 60079-1, ANSI/UL/IEC/CAN/ CSA-C22.2 60079-31
	EMC EN 60032 Class A, EN 50121-4, IEC 62236-4, EN 60024, EN 61000-6-1, EN 61000-6-2, FCC Part 15 Subpart B Class A, ICES-003 Class A, VCCI Class A, RCM AS/NZS CISPR 32 Class A, KC KN32 Class A, KC KN35
	Safety IEC/EN/UL 60950-22, IEC/EN/UL 62368-1, IS 13252
	Environment IEC 60068-2-1, IEC 60068-2-2, IEC 60068-2-6, IEC 60068-2-14, IEC 60068-2-27, IEC 60068-2-78, IEC/EN 60529 IP66/IP67, IEC/EN 62262 IK10, NEMA 250 Type 4X, NEMA TS 2 (2.2.7-2.2.9)
	Network NIST SP500-267

Explosion-proof certification	USA: FM24US0209X
	Canada: FM24CA0056X
	ATEX: FM24ATEX0026X
	IECEX: IECEX_FMG_24.0028_000

Accessories for the F200



 F2XX-GM General Mount (Supplied with camera)	 F2XX-TO Front Glass Protective Film (Supplied with camera)	 SF-RSK Reliable Securing Kit (Supplied with camera)	 F2XX-WM Fixed Wall Mount	 F2XX-PM Fixed Pole Mount
--	--	---	--	---

Approvals & Dimensions

Non-Wireless Versions

SPECTRUM CAMERA SOLUTIONS SPECIALIZING IN EXPLOSION PROOF TECHNOLOGY
8935 ALMEDA GENOA RD. HOUSTON, TEXAS 77075 USA

FM APPROVED MADE IN USA **CE** 2809

MODEL: F202-SRXE4P-X-IBX-1-01-01
POE INPUT: IEEE 802.3at, 90 Vdc
VAC INPUT: N/A
VDC INPUT: N/A

SERIAL: _____

ENTRY DEVICE ENTRY US/Canada: Class I Division 1 Groups BCD [SEE TABLE 1], Type 4X, IP66

TEMP CODE	AMB TEMP RANGE	TEMP CODE	AMB TEMP RANGE
T0	-55°C TO +55°C	T1	-55°C TO +55°C
T2	-55°C TO +55°C	T3	-55°C TO +55°C
T4	-55°C TO +55°C	T5	-55°C TO +55°C

Class II/III Division 1 Groups EFG [SEE TABLE 2], Type 4X, IP66

Class I, Zone 1, AEx/Ex db IIB+H2 Gb [SEE TABLE 1], Type 4X, IP66

Zone Z1, AEx/Ex mb tb IIIC Db [SEE TABLE 3], Type 4X, IP66

Ex II 2 G Ex db IIB+H2 Gb [SEE TABLE 1], IP66

Ex II 2 D Ex tb IIIC Db [SEE TABLE 1], IP66

CERT NO. FM24US02009X & FM24CA0056XCEv FMG 24.0028X, & FM24ATEX0028X
WARNING: DO NOT OPEN WHEN ENERGIZED OR WHEN AN EXPLOSIVE ATMOSPHERE MAY BE PRESENT. Install seal within 18 inches.
WARNING: POTENTIAL ELECTROSTATIC CHARGING HAZARD - SEE INSTRUCTION NOTE. FOR BATTERY REPLACEMENT DETAILS- SEE INSTRUCTION
AVERTISSEMENT: NE PAS OUVRIER LORSQU'ENNERGISE OU QUAND UNE ATMOSPHERE EXPLOSIVE PEUT ETRE PRESENTE. Les joints de fermeture sont obligatoires dans une distance de 18 pouces.
AVERTISSEMENT - RISQUE DE CHARGE ELECTROSTATIQUE POTENTIEL - VOIR LES INSTRUCTIONS. REMARQUE : POUR LES DETAILS SUR LE REMPLACEMENT DE LA BATTERIE, VOIR LES INSTRUCTIONS.

Wireless Versions

SPECTRUM CAMERA SOLUTIONS SPECIALIZING IN EXPLOSION PROOF TECHNOLOGY
8935 ALMEDA GENOA RD. HOUSTON, TEXAS 77075 USA

FM APPROVED MADE IN USA **CE** 2809

MODEL: F202-SRXE4P-X-IBX-1-02-03-02-RUTZ41
POE INPUT: N/A
VAC INPUT: 100-240 VAC, 50W, 50/60 Hz
VDC INPUT: N/A

SERIAL: _____

ENTRY DEVICE ENTRY US/Canada: Class I Division 1 Groups BCD [SEE TABLE 1], Type 4X, IP66

TEMP CODE	AMB TEMP RANGE	TEMP CODE	AMB TEMP RANGE
T0	-55°C TO +55°C	T1	-55°C TO +55°C
T2	-55°C TO +55°C	T3	-55°C TO +55°C
T4	-55°C TO +55°C	T5	-55°C TO +55°C

Class II/III Division 1 Groups EFG [SEE TABLE 2], Type 4X, IP66

Class I, Zone 1, AEx/Ex db mb [Ia Ga] IIB+H2 Gb [SEE TABLE 1], Type 4X, IP66

Zone Z1, AEx/Ex mb tb [Ia Da] IIIC Db [SEE TABLE 3], Type 4X, IP66

Ex II 2 (1) G Ex db mb [Ia Ga] IIB+H2 Gb [SEE TABLE 1], IP66

Ex II 2 (1) D Ex mb tb [Ia Da] IIIC Db [SEE TABLE 1], IP66

CERT NO. FM24US02009X & FM24CA0056XCEv FMG 24.0028X, & FM24ATEX0028X
WARNING: DO NOT OPEN WHEN ENERGIZED OR WHEN AN EXPLOSIVE ATMOSPHERE MAY BE PRESENT. Install seal within 18 inches.
WARNING: POTENTIAL ELECTROSTATIC CHARGING HAZARD - SEE INSTRUCTION NOTE. FOR BATTERY REPLACEMENT DETAILS- SEE INSTRUCTION
AVERTISSEMENT: NE PAS OUVRIER LORSQU'ENNERGISE OU QUAND UNE ATMOSPHERE EXPLOSIVE PEUT ETRE PRESENTE. Les joints de fermeture sont obligatoires dans une distance de 18 pouces.
AVERTISSEMENT - RISQUE DE CHARGE ELECTROSTATIQUE POTENTIEL - VOIR LES INSTRUCTIONS. REMARQUE : POUR LES DETAILS SUR LE REMPLACEMENT DE LA BATTERIE, VOIR LES INSTRUCTIONS.

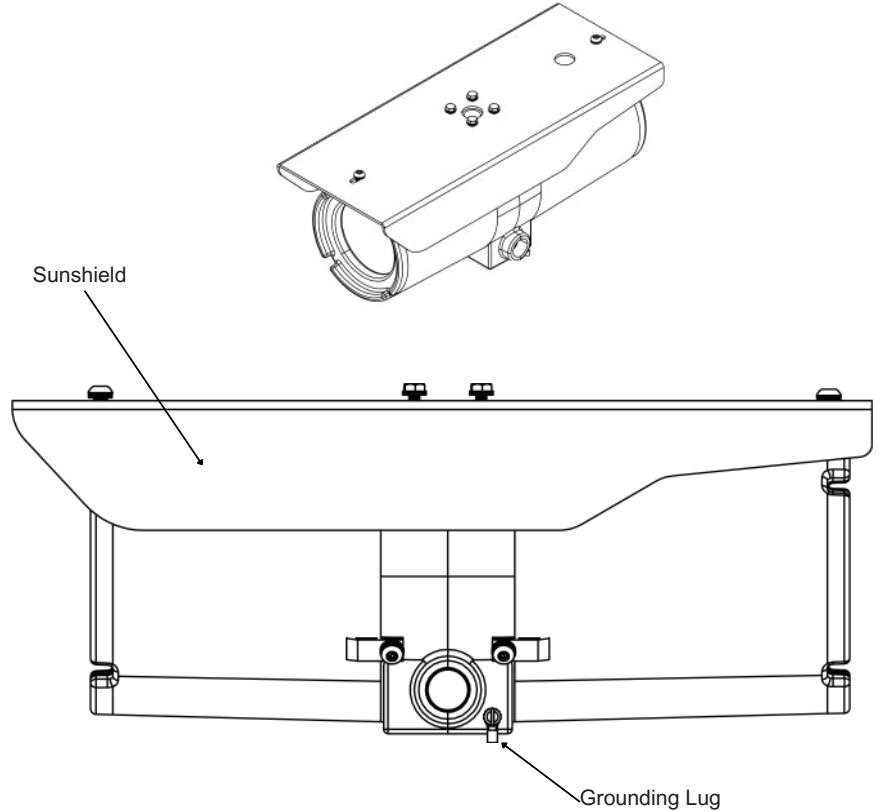
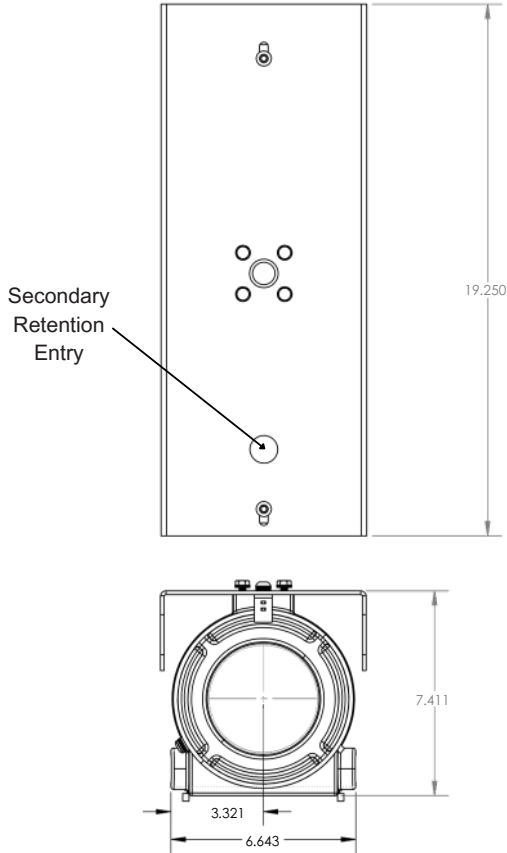

Installation Cable & Gland Kits

Suitable for installation in Class I, II, III, Div 1, ABCDEFG IEC - Zone 1/21 IIC, IIIC environments.

The cable gland is supplied pre-installed onto one end of the 3-core cable.

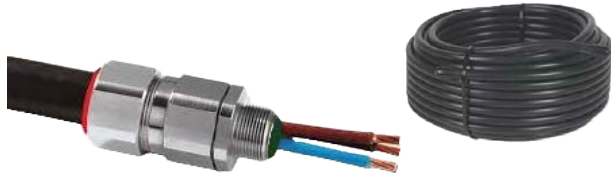

- SCS-PWR-CBL-3C-D1-Z1-25 - (25 ft)
- SCS-PWR-CBL-3C-D1-Z1-50 - (50 ft)
- SCS-PWR-CBL-3C-D1-Z1-100 - (100 ft)
- SCS-PWR-CBL-3C-D1-Z1-200 - (200 ft)
- SCS-PWR-CBL-3C-D1-Z1-300 - (300 ft)

For additional sizes please contact us at sales@spectrumcamera.com

For use with the 120 / 240 VAC
F200 models only